



REPLACEMENT PARTS LIST

**Inverter Multi Zone Outdoor
Ductless Mini Split**

A-VHP284SA-1

EXPLODED VIEW

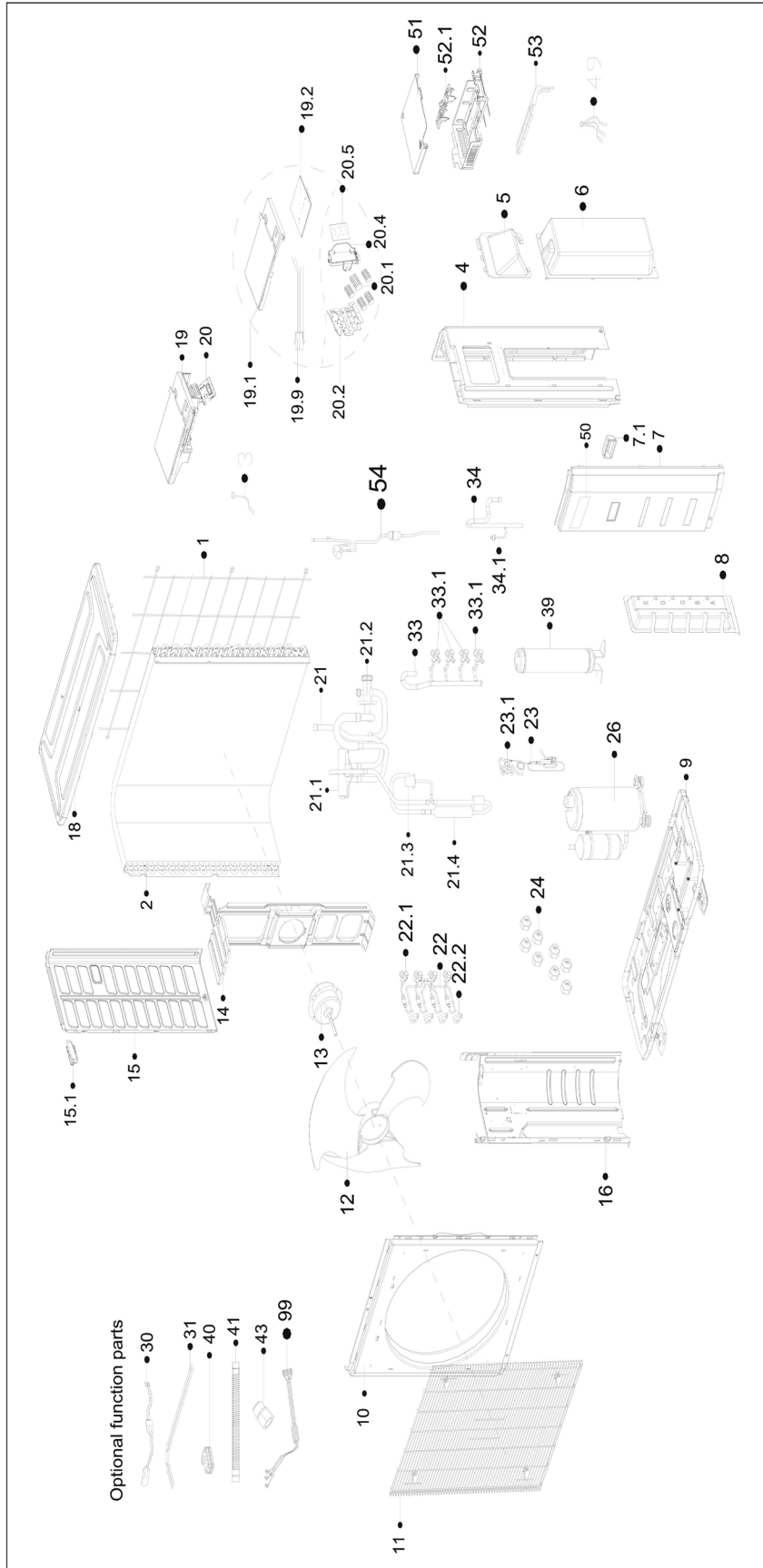

REPLACEMENT PARTS

Location	Part Name	Quantity	Part No.
1	Rear Grille	1.0	12222000006604
2	Condenser assembly	1.0	15822000015246
3	Pipe temperature sensor subassembly	1.0	11201007007263
4	rear right side plate assembly	1.0	12222000017146
5	handle	1.0	12222000011085
6	Water collector	1.0	12122300000110
7	front right side plate assembly	1.0	12222500002952
7.1	Handle	1.0	12100702000038
8	Valve plate	1.0	12222000005282
9	Chassis assembly	1.0	12222000005267
10	Front panel	1.0	12222000A01431
11	Air outlet grille	1.0	12222000014845
12	axial flow fan	1.0	12100105000084
13	Brushless DC motor	1.0	11002015020012
14	Motor bracket assembly	1.0	12222000017446
15	Left supporter	1.0	12222000006665
15.1	Small handle	1.0	12100701000033
16	Partition board subassembly	1.0	12222000018085
18	Top cover assembly	1.0	12222500000587
19	Electronic control box subassembly	1.0	17222300004810
19.1	Cover of electronic control box	1.0	12122000034104
19.2	Outdoor main control board subassembly	1.0	17122300008939
19.9	Fan motor wire joint subassembly	1.0	17401203026201
20	Electronic control box terminal board assembly	1.0	17222300004809
20.1	Terminal block	4.0	17400401006029
20.1	Terminal block	1.0	17400401005217
20.2	Terminal board assembly	1.0	12222000019185
20.4	DR Installing Foundation	1.0	12122000028845
20.5	Key board assembly	1.0	17122000063339
21	4-way valve assembly	1.0	15422000025818
21.1	4-way valve	1.0	15500216002363
21.2	Gas valve	1.0	15500204000664
21.3	Pressure switch	1.0	17400516000851
21.4	Muffler	1.0	15122000034182
22	High pressure valve assembly	1.0	15422300000765
22.1	High pressure valve	4.0	15500208000028
22.2	Electronic expansion valve subassembly	4.0	11501020000281
23	High pressure valve assembly	1.0	15422000025789
23.1	High pressure valve	1.0	15500208000047
24	Copper nut	4.0	15500406000016
24	Copper nut	1.0	15500406000012
24	Copper nut	3.0	15500406000010
26	compressor	1.0	11103020000719
30	Electric heater of chassis	1.0	17402002000466
31	Crankcase electric heater	1.0	17402001000601
33	Gas valve	1.0	15422300000865
33.1	Gas valve	1.0	15500204000667
33.1	Gas valve	3.0	15500204000665
34	compressor suction pipe assembly	1.0	15122000034183
34.1	Pressure switch	1.0	17400516000009
39	accumulator cylinder	1.0	15500508001555
43	Transfer connector	1.0	15500303002547
43	Transfer connector	1.0	15500303002546
43	Transfer connector	1.0	15500303002545
43	Transfer connector	1.0	15500303002544
49	combination sensor	1.0	11201011001107
50	Outdoor unit trademark	1.0	16000201001228
51	Cover of electronic control box	1.0	12222000018405
52	Electronic installing box	1.0	12222000018625
52.1	U-Typed Support with Copper Pipe	1.0	12122000033782
53	Radiator subassembly	1.0	15122000033883
54	Electronic expansion valve subassembly	1.0	15422000025787
99	Compressor wire assembly	1.0	17401203000751

Due to ongoing product improvements, specifications and dimensions are subject to change and correction without notice or incurring obligations. Determining the application and suitability for use of any product is the responsibility of the installer. Additionally, the installer is responsible for verifying dimensional data on the actual product prior to beginning any installation preparations.

Incentive and rebate programs have precise requirements as to product performance and certification. All products meet applicable regulations in effect on date of manufacture; however, certifications are not necessarily granted for the life of a product. Therefore, it is the responsibility of the applicant to determine whether a specific model qualifies for these incentive/rebate programs.



1900 Wellworth Avenue • Jackson, MI 49203 • 517-787-2100